

TECHNICAL DATA

Concrete Placing Boom

MODEL : EPB 36 CL

CONTENTS

1. SPECIFICATION

2. SUPPLY SCOPE

- STANDARD MODEL
- STANDARD ITEMS
- OPTION ITEMS
- ACCESSORIES LIST

3. WORKING RANGE

4. MAIN PARTS

- PLACING BOOM ASSEMBLY
- BOOM ASS'Y
- MAST(COLUMN)
- MAST BRACKET
- PEDESTAL ASSEMBLY
- BASE FRAME & MAST ANCHOR (OPTION)
- CLIMBING CYLINDER
- WORKING PLATFORM
- LADDER WITH GRID & LADDER WITHOUT GRID
- ADAPTER

1. SPECIFICATION

| ITEM | | Unit | EPB 36 CL | Remarks |
|---------------------------|-------------|--------------------|----------------------|--------------------|
| Boom Specs | | | | |
| Boom Type | | - | 4 - R Boom | |
| Horizontal reach | | m | 35.5 | |
| Reach depth | | m | 29.6 | including end hose |
| End Hose | | M | 3 | |
| Boom reach | 1st Section | mm | 9,500 | |
| | 2nd Section | mm | 8,600 | |
| | 3rd Section | mm | 8,600 | |
| | 4th Section | mm | 8,600 | |
| Boom Articulation | 1st Section | ° | 80 | |
| | 2nd Section | ° | 180 | |
| | 3rd Section | ° | 180 | |
| | 4th Section | ° | 240 | |
| General Specs | | | | |
| Mast Height | | m | 20(10mx2EA) | |
| Pipeline Diameter | | mm | 125 | |
| Rotation Speed | | rpm | 0.5 | |
| Rotation Degree | | ° | 370 | |
| Generating Power | | kW | 18 | |
| Concrete Output | | m ³ /hr | 15 – 150 | |
| Main Power | | V / Hz | 380V / 50Hz | |
| Control System | Standard | - | Wire Remote Control | |
| | Option | - | Radio Remote Control | Wireless |
| Weight | | | | |
| Boom Weight | | Kg | 5,250 | |
| Pedestal + Adapter Weight | | Kg | 5,200 | |

2. SUPPLY SCOPE

[STANDARD MODEL]

| NO. | DESCRIPTION | UNIT | MODEL |
|-----|----------------------------|---------|----------------|
| 1 | Concrete Placing Boom | unit(s) | EPB 36 CL |
| 2 | Application for pump truck | | NO APPLICATION |

[STANDARD ITEMS]

| NO. | DESCRIPTION | UNIT | EPB 36 CL |
|-----|--------------------------------------|---------|-----------|
| 1 | Concrete Placing Boom M36 | unit(s) | 1 |
| 2 | Pedestal for EPB | unit(s) | 1 |
| 3 | Mast (750mmx750mmx10m) | unit(s) | 2 |
| 4 | Mast Bracket | set(s) | 3 |
| 5 | Mast Pin | ea | 2 |
| 6 | Wire Remote Control | set(s) | 1 |
| 7 | End Hose - 3m | ea | 1 |
| 8 | Climbing Cylinder | ea | 2 |
| 9 | Climbing Cylinder Hyd' Hose - 20m | set(s) | 1 |
| 10 | Climbing Control Switch | set(s) | 1 |
| 11 | Adapter | ea | 1 |
| 12 | Working Platform | set(s) | 1 |
| 13 | Ladder (With gide:3, Without:1) : 2m | ea | 4 |
| 14 | Bolt & Nut (M30X400L):32ea | set(s) | 1 |
| 15 | Accessories | Set(s) | 1 |

[OPTION ITEMS]

| NO. | DESCRIPTION | UNIT | EPB 36 CL |
|-----|------------------------------------|---------|-----------------------------------------------|
| 1 | Base Frame (including Anchor Mast) | unit(s) | Max freestanding 10mx2 without counter weight |
| 2 | Radio Remote Control | set(s) | |
| 3 | Delivery Pipes/Clamps | Set(s) | |
| 4 | Lifting wire rope | Set(s) | |
| 5 | Power Cable | m | |

[ACCESSORIES LIST]

| No. | Part No. | Descriptions | Spec. | Unit | Q'ty |
|-----|--------------|--------------------|---------------|------|------|
| 1 | H2140004-01 | TOOLS (HAMMER) | STD | set | 1 |
| 2 | 181-00188D4 | UNION NUT | M12L | ea | 10 |
| 3 | 181-00188D6 | UNION NUT | M18L | ea | 2 |
| 4 | 181-00187D4 | RING;THRUST | DR12L/S | ea | 10 |
| 5 | 181-00187D6 | RING;THRUST | DR18L | ea | 2 |
| 6 | 181-00254D7 | PLUG | VS 12L/S | ea | 10 |
| 7 | 181-00254D9 | PLUG | VS 18L | ea | 2 |
| 8 | 181-00204D7 | COUPLING;STRAIGHT | GS 12L | ea | 10 |
| 9 | 181-00204D9 | COUPLING;STRAIGHT | GS 18L | ea | 2 |
| 10 | 181-00252D4 | COUPLING;STRAIGHT | SNV 12L | ea | 4 |
| 11 | 181-00202D29 | COUPLING;MALE STUD | GES12L/R1/2-W | ea | 4 |
| 12 | 96330001.04 | HYD. HOSE | 12L-600L | ea | 1 |
| 13 | 96330001.101 | HYD. HOSE | 18L-500L | ea | 1 |
| 14 | H2080352 | HYD. HOSE | 25S-900L D90 | ea | 1 |
| 15 | 96330001.147 | HYD. HOSE | 12S-1650L | ea | 1 |
| 16 | 474-00013 | FILTER INSERT | 10 MICRON | ea | 1 |
| 17 | H2140098 | ELEC. SPARE PARTS | DC24V | SET | 1 |
| 18 | 26620120A | COUPLING ASS'Y | D125 | ea | 2 |
| 19 | 93930011A | PACKING | 5.5" | ea | 6 |
| 20 | 29620002 | SPONGE RUBBER BALL | D125 | ea | 1 |
| 21 | 2660033B | ELBOW 90' | 5.5" | ea | 1 |
| 22 | H2080325 | FILTER ELEMENT | FOR BOOM | ea | 1 |
| 23 | 26600023 | MT SCREW COUPLING | 5.5" | ea | 1 |
| 24 | 26630113 | SPACER | 6t | ea | 2 |
| 25 | 91730014 | SPRING PIN | | ea | 3 |
| 26 | - | MANUAL&PART LIST | | ea | 2 |

Working Range

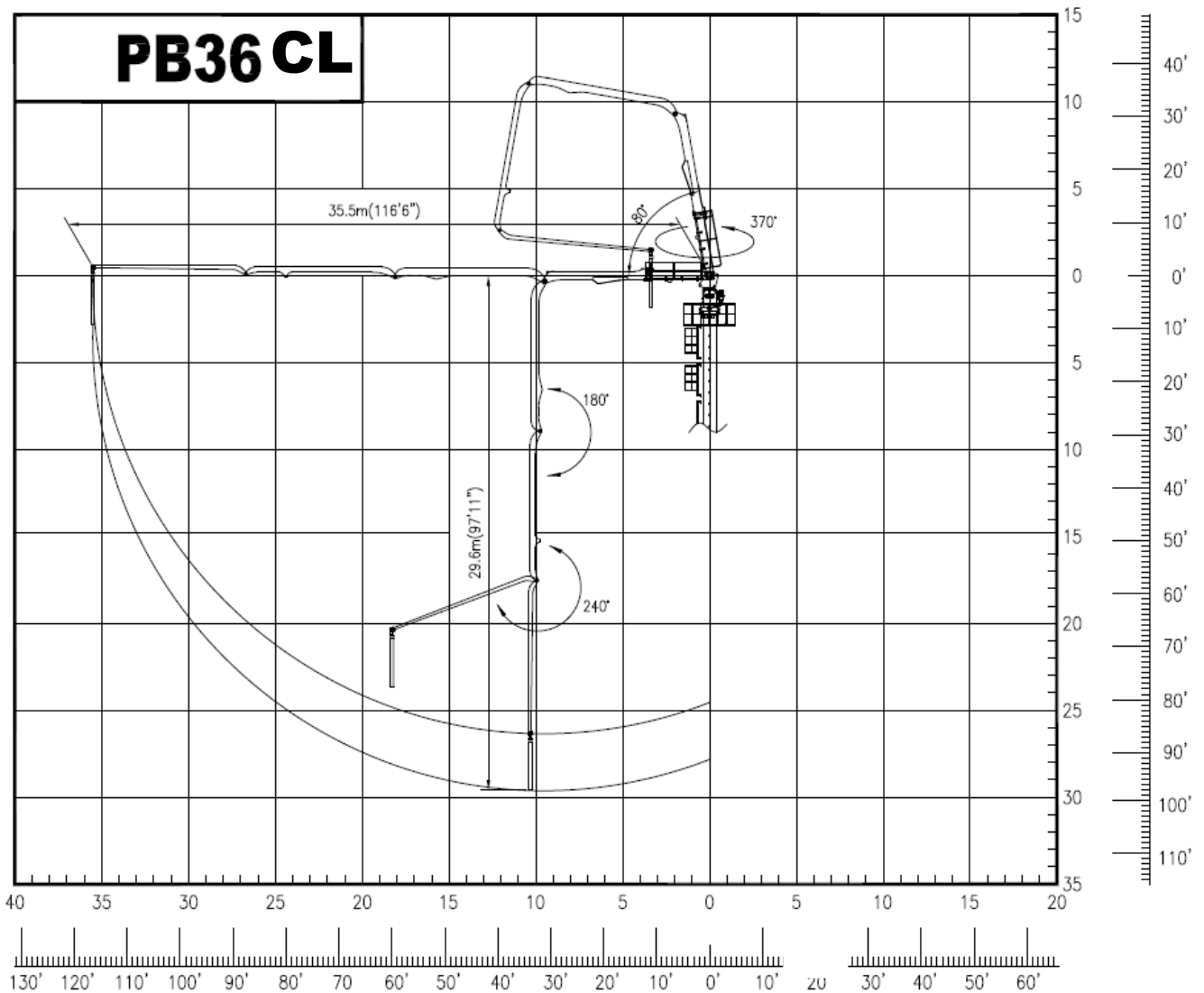

UNIT:m(ft.in)

Placing Boom Assembly

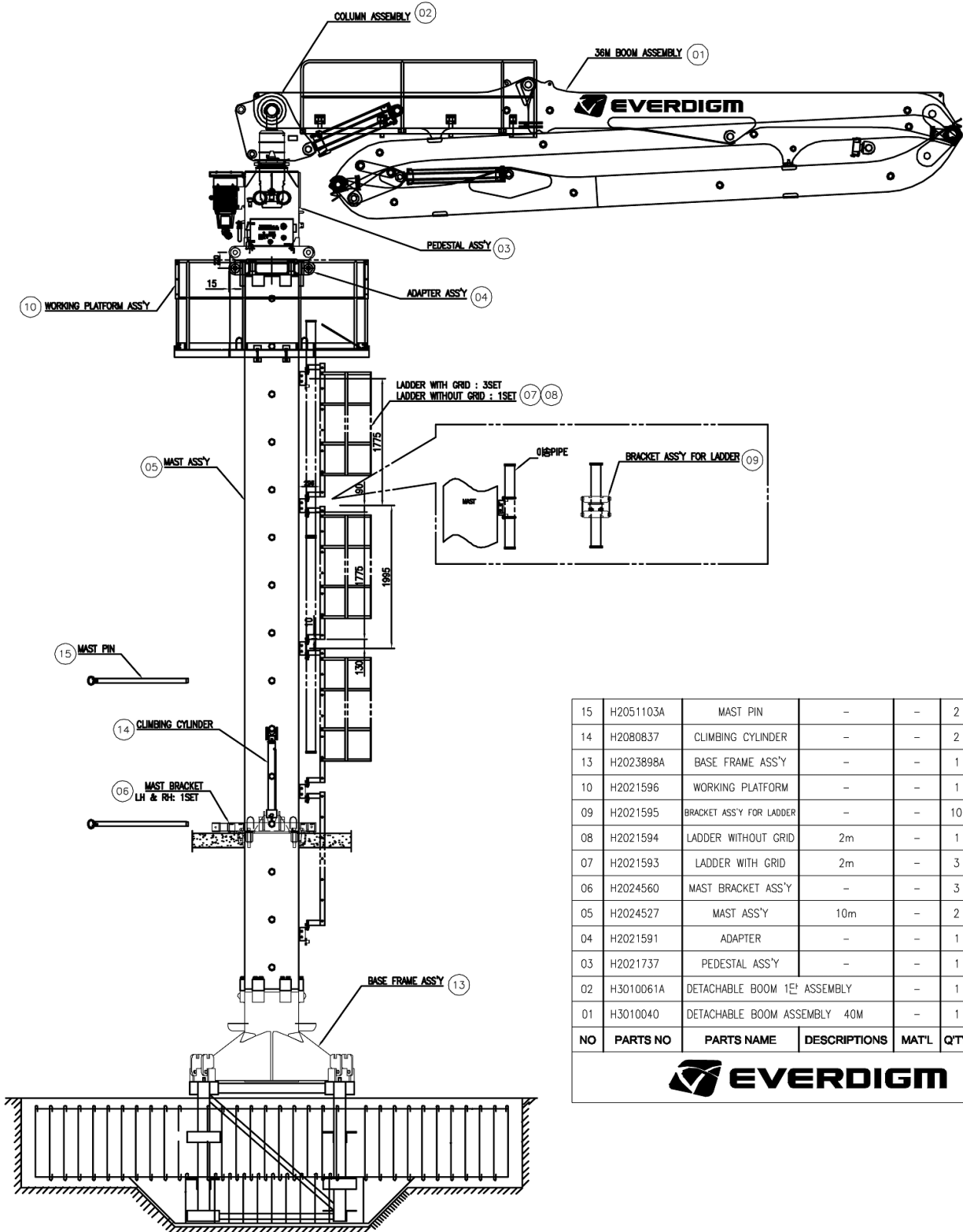

| 15 | H2051103A | MAST PIN | - | - | 2 | 36M Only |
|----|-----------|------------------------------|--------------|-------|------|----------|
| 14 | H2080837 | CLIMBING CYLINDER | - | - | 2 | 36M Only |
| 13 | H2023898A | BASE FRAME ASS'Y | - | - | 1 | OPTION |
| 10 | H2021596 | WORKING PLATFORM | - | - | 1 | - |
| 09 | H2021595 | BRACKET ASS'Y FOR LADDER | - | - | 10 | - |
| 08 | H2021594 | LADDER WITHOUT GRID | 2m | - | 1 | - |
| 07 | H2021593 | LADDER WITH GRID | 2m | - | 3 | - |
| 06 | H2024560 | MAST BRACKET ASS'Y | - | - | 3 | 36M Only |
| 05 | H2024527 | MAST ASS'Y | 10m | - | 2 | 36M Only |
| 04 | H2021591 | ADAPTER | - | - | 1 | - |
| 03 | H2021737 | PEDESTAL ASS'Y | - | - | 1 | - |
| 02 | H3010061A | DETACHABLE BOOM 1E' ASSEMBLY | - | - | 1 | - |
| 01 | H3010040 | DETACHABLE BOOM ASSEMBLY 40M | - | - | 1 | - |
| NO | PARTS NO | PARTS NAME | DESCRIPTIONS | MAT'L | Q'TY | REMARKS |

Boom Assy

5,250kg

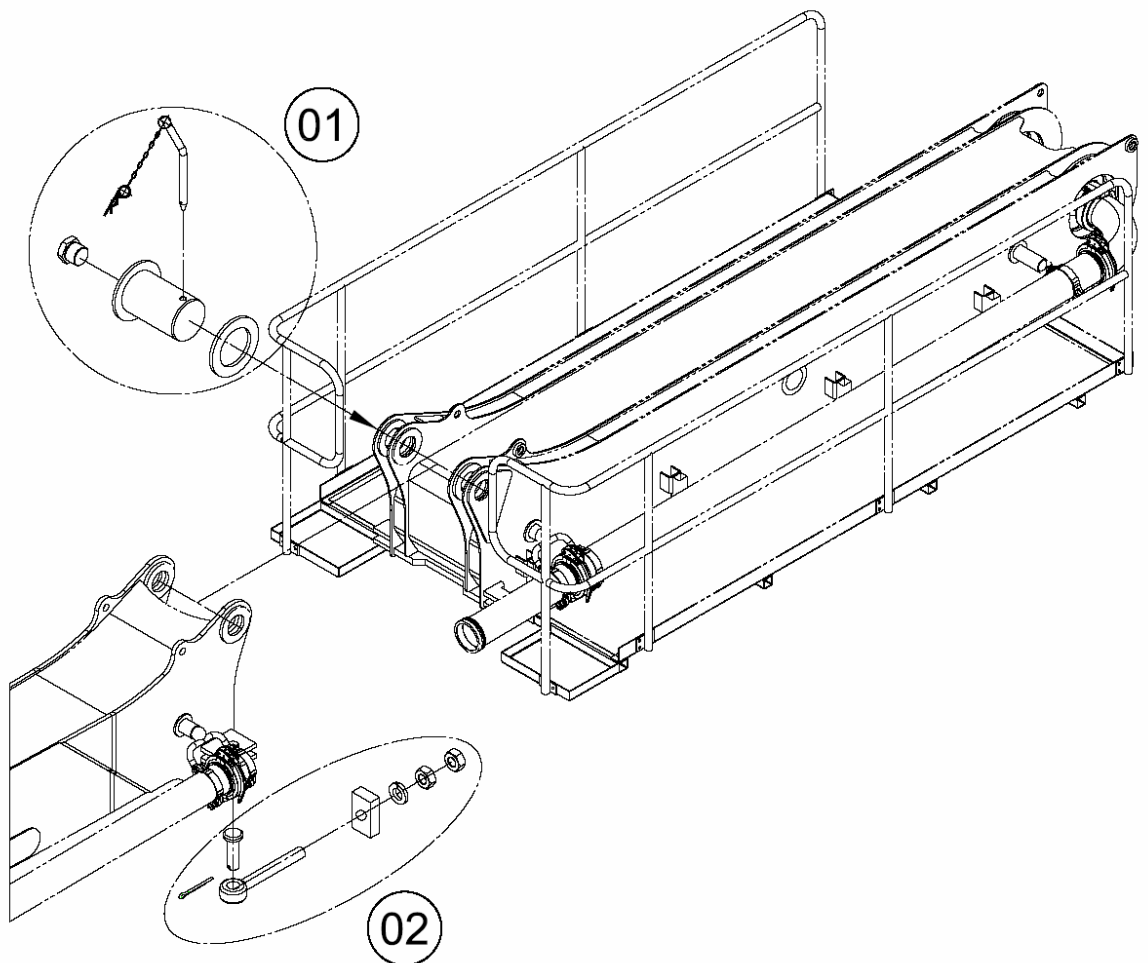
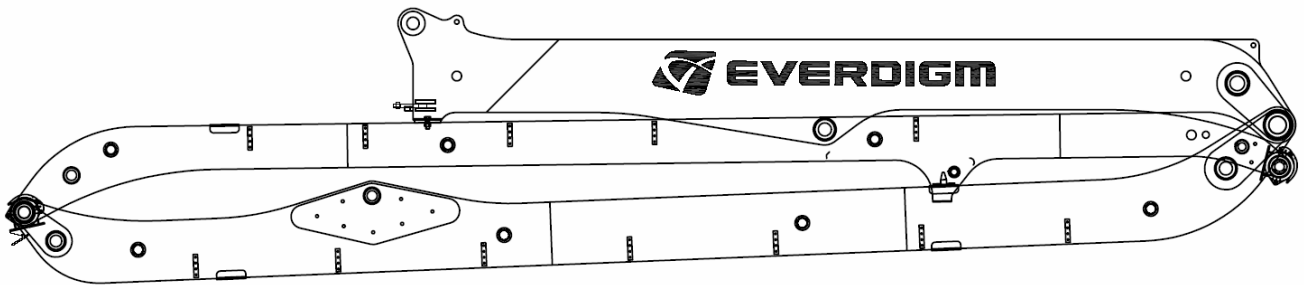

EPB Placing Boom
Mast (Column)

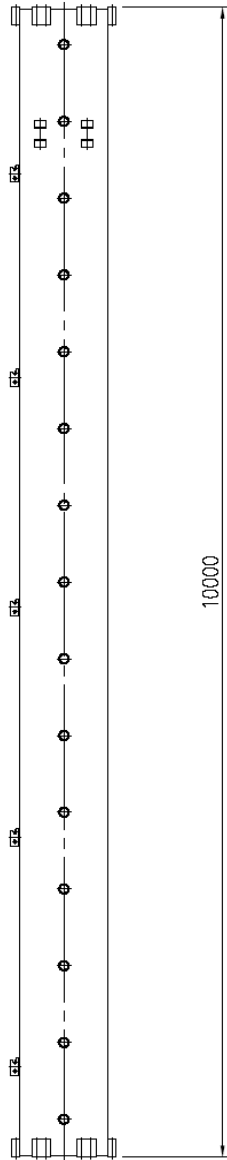

Weight = **3,500kg**

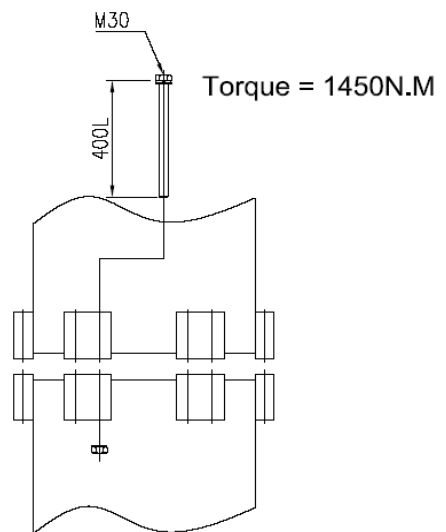
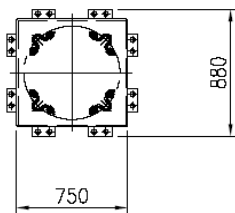

EPB Placing Boom
Mast Bracket

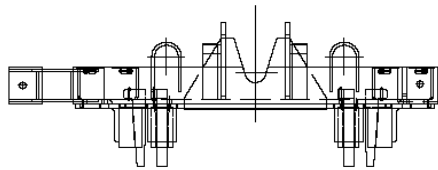
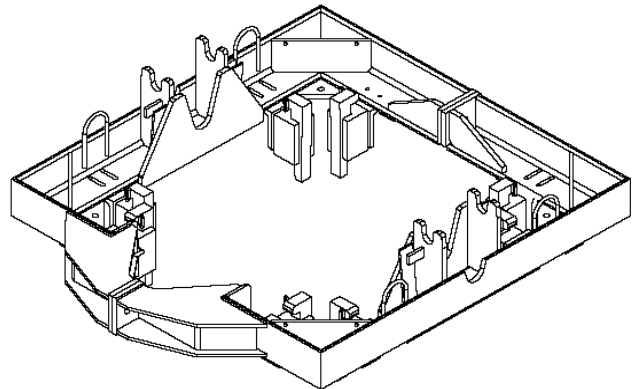
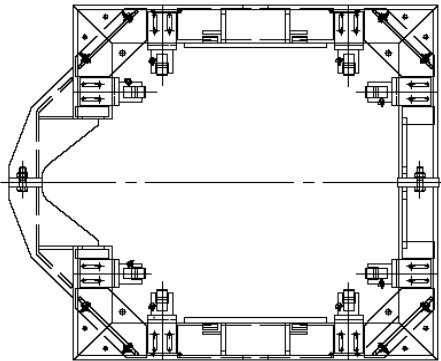

Weight = **410kg**

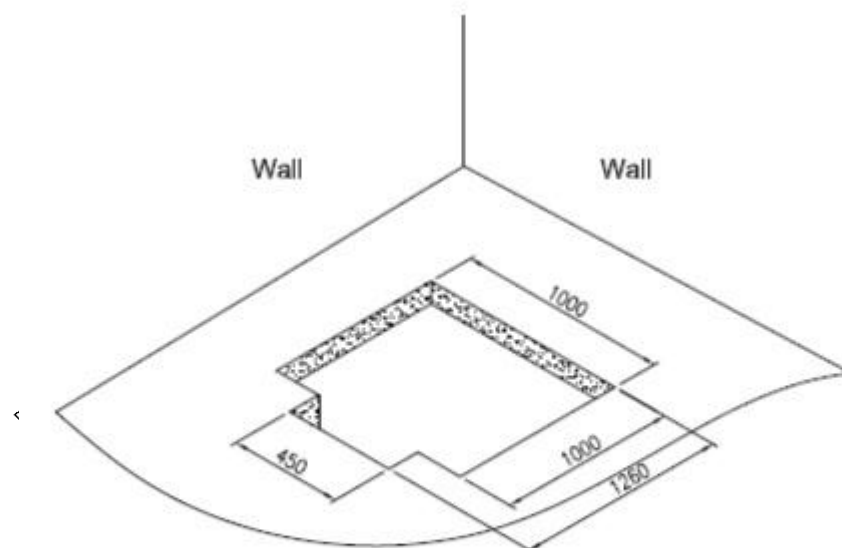

* Floor Cutting Dimension

Pedestal Assembly

4,950kg

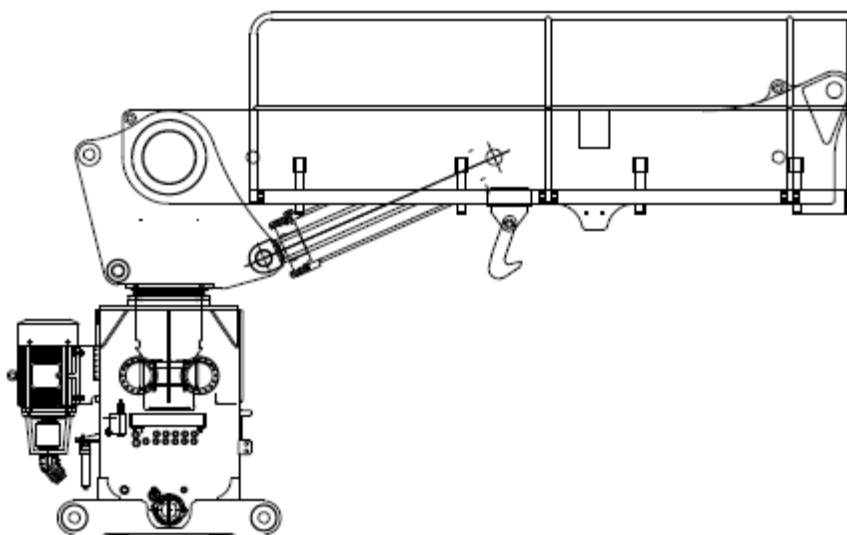

Base Frame & Anchor Mast (Option)

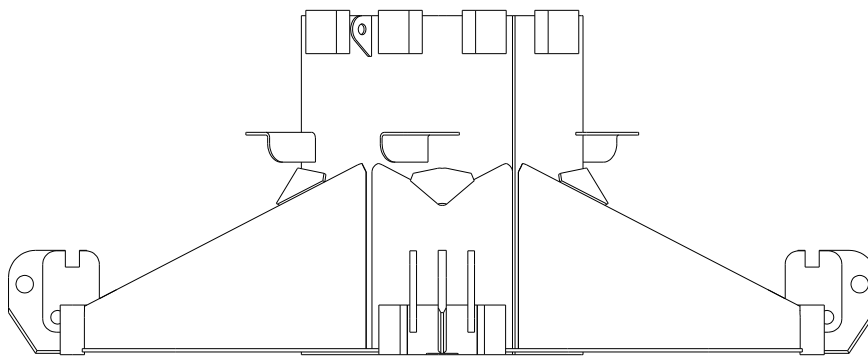
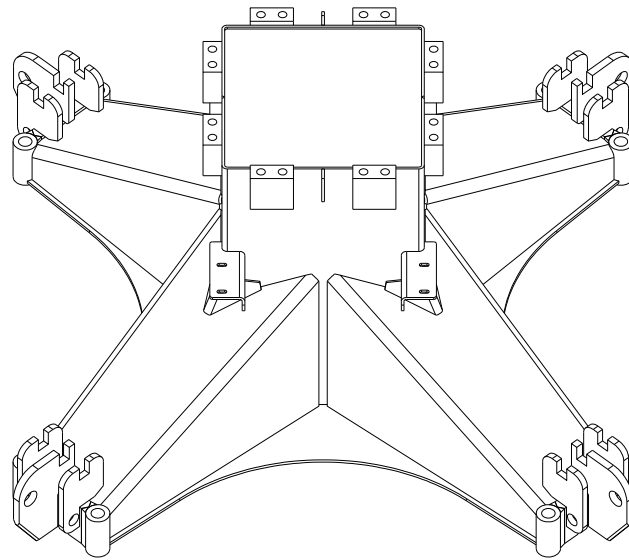

1425Kg

Base Frame & Anchor Mast (Option)

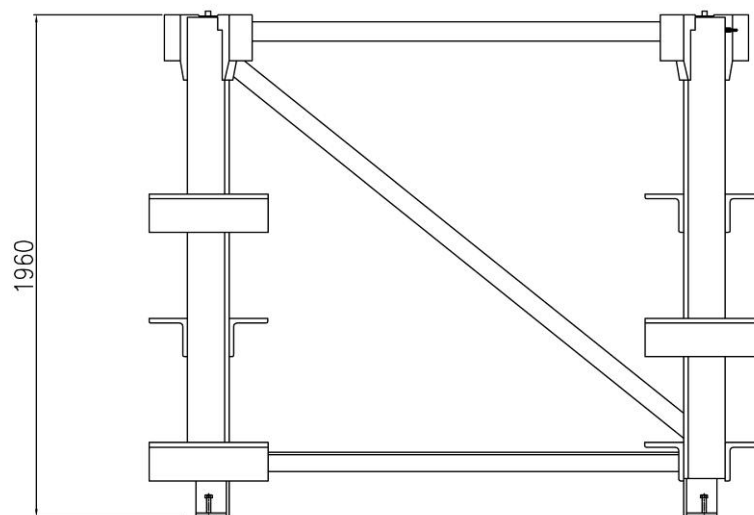
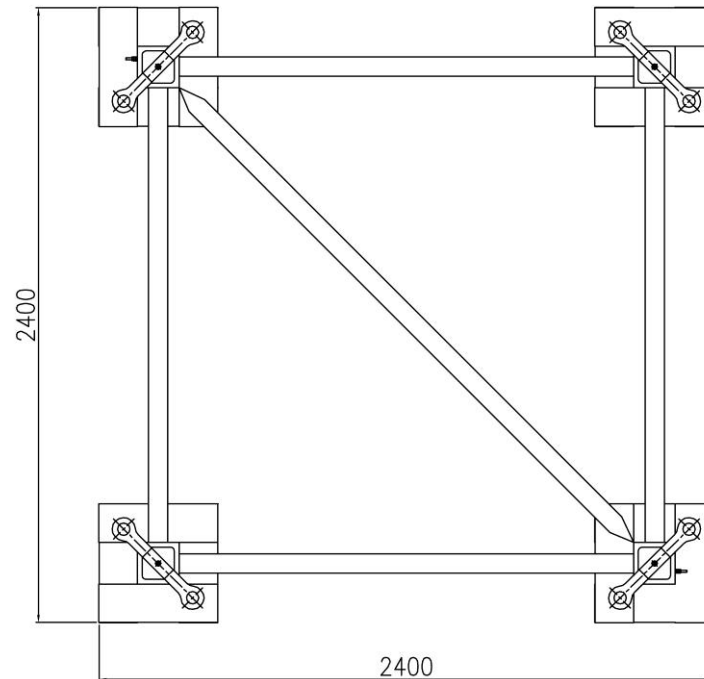

Weight=1,440Kg

EPB Placing Boom
Climbing Cylinder

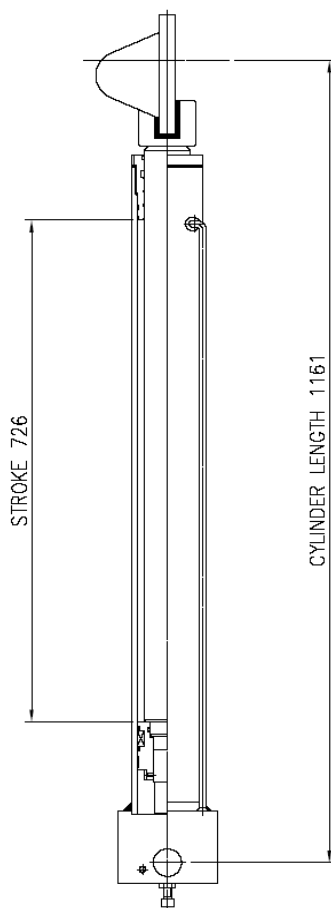
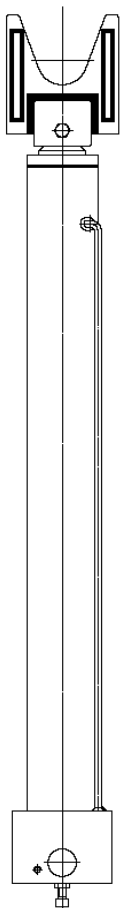
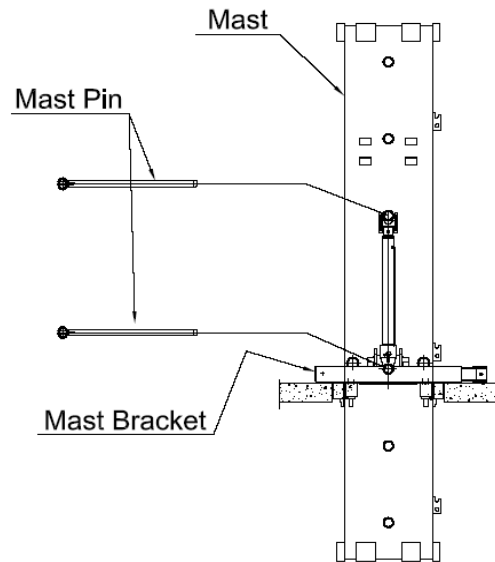

EPB Placing Boom
Working Platform

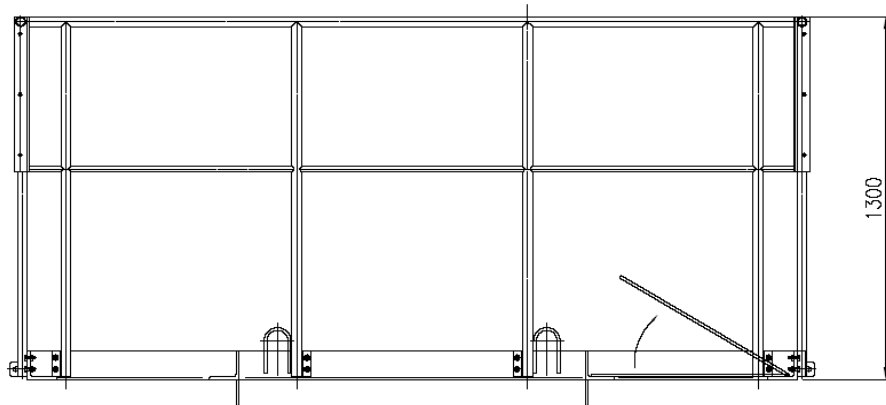
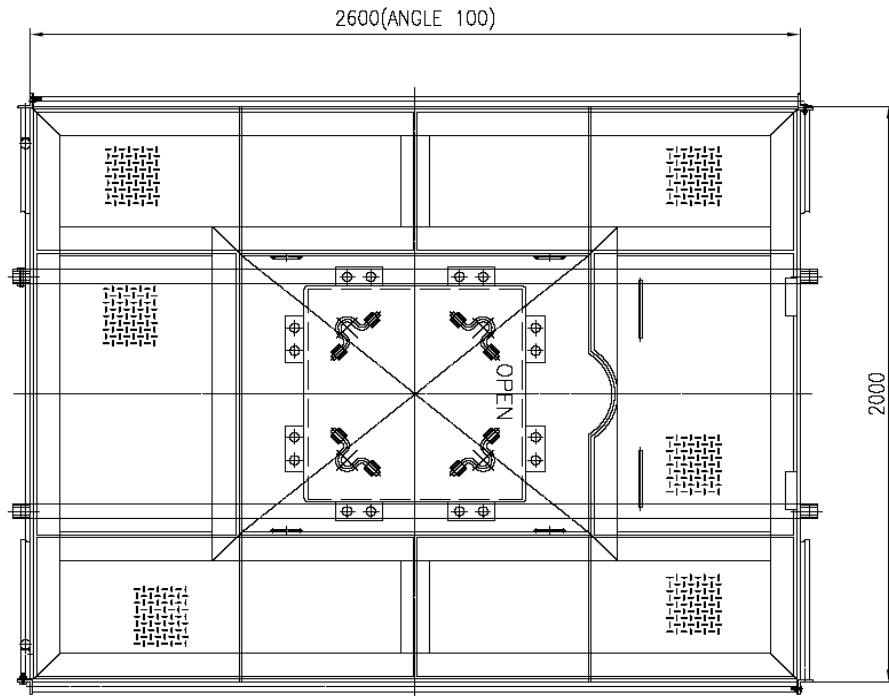

Weight = 450Kg

EPB Placing Boom
Ladder With Grid & Ladder Without Grid

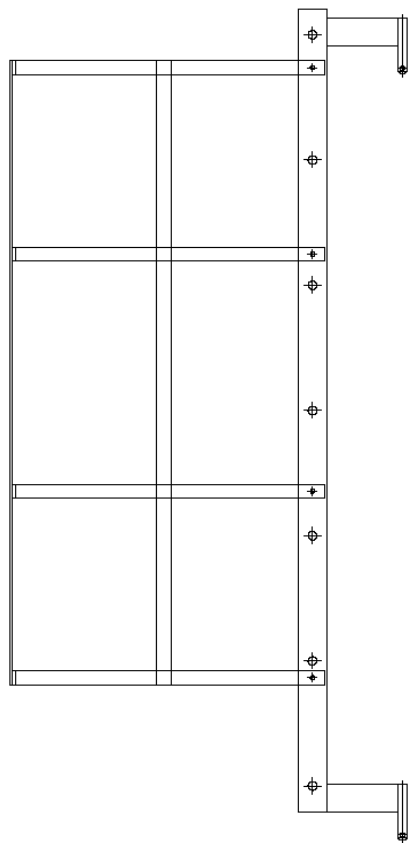
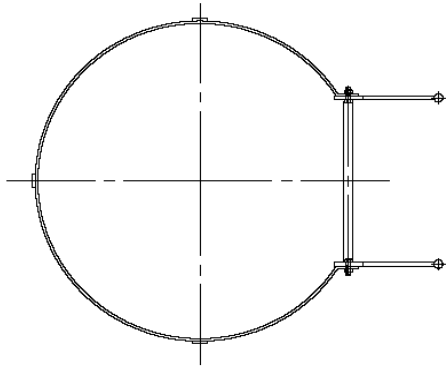

Weight = 40Kg

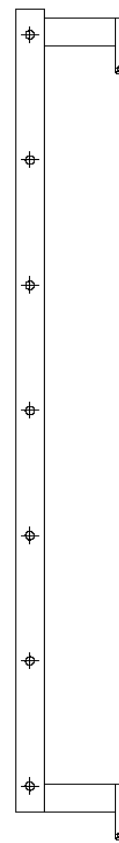

Weight = 25Kg

EPB Placing Boom
Adapter

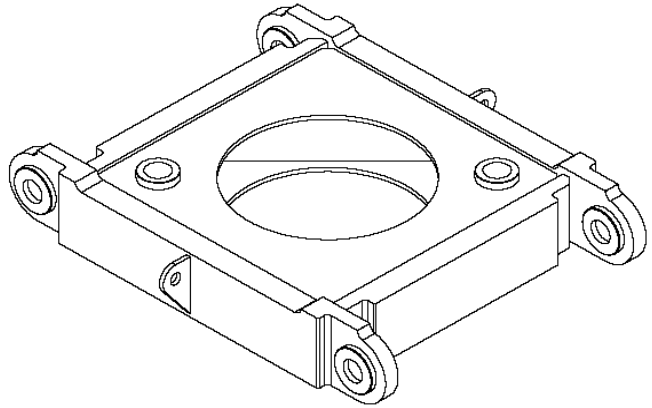

Weight = 500Kg

